

ELECTRIC COOKER 4 GLASS-CERAMIC ZONES ON OPEN COMPARTMENT

Project
Rev.:
Zone:
Location:



CODICE
CR1015969T4W

MODELLO
QT90PCV/VCE800-T4W

SERIE
BARON 4.0

GENERAL CHARACTERISTICS

From the solid foundation of Baron tradition, comes the new Queen 4.0 kitchen, even more practical, more accessorized, more technological.

An evolution in the field of professional kitchens.

Queen 4.0 is perfectly designed in detail to speed up and simplify every task of preparation, cooking, tidying up, and cleaning in the kitchen, and stand by you every day as a true ally in your work.



TECHNICAL SPECIFICATIONS

Unbreakable watertight glass-ceramic top.
Cooking zones marked with 27x27 cm square silkscreen printing.
4 kw single zone power.
Temperature regulation from 70-450°C by thermostat.
Possibility of setting 2 timers to control cooking.
An acoustic signal alerts the operator at the end of the set time.

A temperature regulator sets the temperature and this permits to select two sizes of the heating zone according to the size of the pot bottom.

Firing surface temperature 70° to 450° C

Data collection, operation monitoring, remote control are just some of the possibilities that connectivity puts at your disposal.

Thanks to the jet-proofing certification (IPX5) obtained through specific tests, knobs and under-knobs can be washed at the end of the working day without compromising functionality and safety.

The front bar is a comfortable foothold for the cook; it keeps a safe distance from the worktop and thus protects against accidental collisions with what is resting on the worktops and at the same time the handles.

ELECTRIC COOKER 4 GLASS-CERAMIC ZONES ON OPEN COMPARTMENT

Project
Rev.:
Zone:
Location:



CODICE
CR1015969T4W

MODELLO
QT90PCV/VCE800-T4W

SERIE
BARON 4.0

Technical Information

| SPECIFICATION | DATA |
|-----------------------|---|
| MATERIAL | CR1015969T4W |
| DEFINITION | QT90NPCV/VCE800-T4W VETROC. ELE.M80 A/G |
| COMMERCIAL LINE | QUEEN |
| SUPPLY | ELECTRICS |
| DIM. WIDTH | 800 mm |
| DIM. PRODUCTIVITY | 900 mm |
| DIM. HEIGHT | 870 mm |
| NET WEIGHT | 127.8 Kg |
| VOLUME (net) | 0.626 |
| PACKAGE LENGTH | 860 mm |
| PACKAGE WIDTH | 1020 mm |
| PACKAGING HEIGHT | 1150 mm |
| PACKAGE VOLUME | 1,010 m3 |
| GROSS PACKING WEIGHT | 143 Kg |
| STANDARD POWER SUPPLY | 380-415V 3N |
| FREQUENCY | 50-60 Hz |
| ELECTRICAL POWER | 16 kW |
| N. FIRES/PLATES | QUATTRO FUOCHI |
| IP GRADE | IPX5 |

**ELECTRIC COOKER 4 GLASS-CERAMIC ZONES ON
OPEN COMPARTMENT**

Project

Rev.:

Zone:

Location:



CODICE
CR1015969T4W

MODELLO
QT90PCV/VCE800-T4W

SERIE
BARON 4.0

SCHEMA DI INSTALLAZIONE - INSTALLATION DIAGRAM - INSTALLATIONSPLAN - SCHEMA D'INSTALLATION - ESQUEMA DE INSTALACION - INSTALLATIONSCHEMA - INSTALLATIONSRIJNINGAR

MISURE IN mm - DIMENSIONS IN mm - ABMESSUNGEN IN mm
 MESURES EN mm - MEDIDAS EN mm - MATEN IN mm

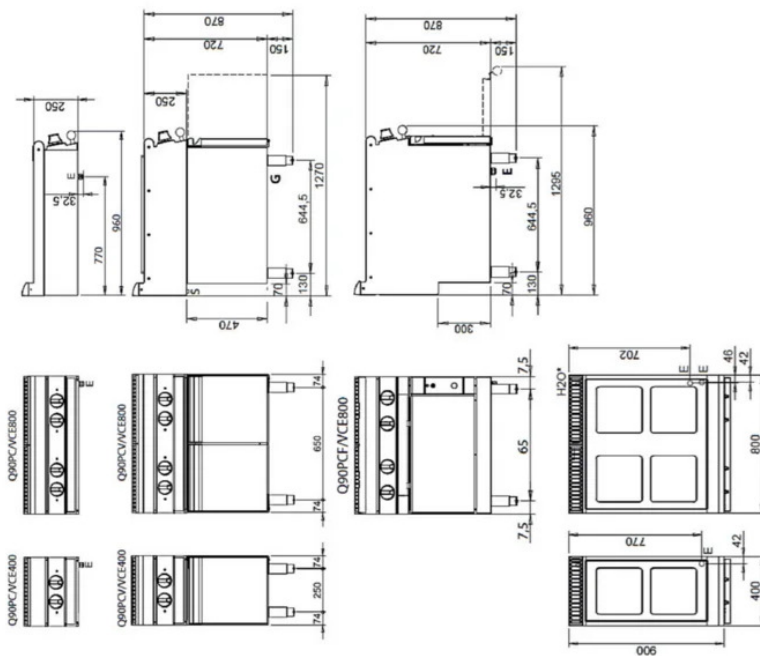

Legenda - Legende - Key - Légende - Leyenda - Legenda

E Pressacavo entrata linea elettrica - Stopfbuchse - Electric cable stress relief
 Presse étoupe de cable él. - Pisacable - Elektrische kabelwartel

H20* Attacco arrivo acqua - Wasseranschluss - Water inlet - Arrivée eau - Union de agua - Wateraansluiting
EN ISO 228-1 G 3/4

ELECTRIC COOKER 4 GLASS-CERAMIC ZONES ON OPEN COMPARTMENT

Project
Rev.:
Zone:
Location:



CODICE
CR1015969T4W

MODELLO
QT90PCV/VCE800-T4W

SERIE
BARON 4.0

PRODUCT'S RANGE PLUS



Possibility of setting 2 timers to control cooking. An acoustic signal warns the operator at the end of the set time.

Industry 4.0 ready version.



Flat flush unbreakable glass for easy handling of pans. Temperature of the cooking surface from 70° to 450° C



Power level control via touch screen and adjustment with ergonomic knob

ELECTRIC COOKER 4 GLASS-CERAMIC ZONES ON OPEN COMPARTMENT

Project
Rev.:
Zone:
Location:



CODICE
CR1015969T4W

MODELLO
QT90PCV/VCE800-T4W

SERIE
BARON 4.0

ACCESSORIES

| CODE | MODELLO | DESCRIZIONE |
|-----------|-------------|----------------------------|
| CR1357499 | 4.0IOTPRO | PRO Subscription - Cloud |
| CR1357479 | 4.0IOTENTRY | ENTRY Subscription - Cloud |