

ELECTRIC COOKER 4 GLASS-CERAMIC ZONES ON OPEN COMPARTMENT

Project
Rev.:
Zone:
Location:



CODICE
CR1015969T4W

MODELLO
QT90PCV/VCE800-T4W

SERIE
BARON 4.0

GENERAL CHARACTERISTICS

From the solid foundation of Baron tradition, comes the new Queen 4.0 kitchen, even more practical, more accessorized, more technological.

An evolution in the field of professional kitchens.

Queen 4.0 is perfectly designed in detail to speed up and simplify every task of preparation, cooking, tidying up, and cleaning in the kitchen, and stand by you every day as a true ally in your work.



TECHNICAL SPECIFICATIONS

Unbreakable watertight glass-ceramic top.

Cooking zones marked with 27x27 cm square silkscreen printing.

4 kw single zone power.

Temperature regulation from 70-450°C by thermostat.

Possibility of setting 2 timers to control cooking.

An acoustic signal alerts the operator at the end of the set time.

The temperature is regulated by means of an energy regulator, which allows two heating zone widths to be selected according to the size of the pan bottom.

Firing surface temperature 70° to 450° C

Data collection, operation monitoring, remote control are just some of the possibilities that connectivity puts at your disposal.

Thanks to the jet-proofing certification (IPX5) obtained through specific tests, knobs and under-knobs can be washed at the end of the working day without compromising functionality and safety.

The front bar is a comfortable foothold for the cook; it keeps a safe distance from the worktop and thus protects against accidental collisions with what is resting on the worktops and at the same time the handles.

ELECTRIC COOKER 4 GLASS-CERAMIC ZONES ON OPEN COMPARTMENT

Project
Rev.:
Zone:
Location:



CODICE
CR1015969T4W

MODELLO
QT90PCV/VCE800-T4W

SERIE
BARON 4.0

Technical Information

SPECIFICATION	DATA
MATERIAL	CR1015969T4W
DEFINITION	QT90NPCV/VCE800-T4W VETROC. ELE.M80 A/G
COMMERCIAL LINE	QUEEN
SUPPLY	ELECTRICS
DIM. WIDTH	800 mm
DIM. PRODUCTIVITY	900 mm
DIM. HEIGHT	870 mm
NET WEIGHT	127.8 Kg
VOLUME (net)	0,626
PACKAGE LENGTH	860 mm
PACKAGE WIDTH	1020 mm
PACKAGING HEIGHT	1150 mm
PACKAGE VOLUME	1,010 m3
GROSS PACKING WEIGHT	143 Kg
STANDARD POWER SUPPLY	380-415V 3N
FREQUENCY	50-60 Hz
ELECTRICAL POWER	16,000 kW
N. FIRES/PLATES	QUATTRO FUOCHI
IP GRADE	IPX5

ELECTRIC COOKER 4 GLASS-CERAMIC ZONES ON OPEN COMPARTMENT

Project
Rev.:
Zone:
Location:



CODICE
CR1015969T4W

MODELLO
QT90PCV/VCE800-T4W

SERIE
BARON 4.0

SCHEMA DI INSTALLAZIONE - INSTALLATION DIAGRAM - INSTALLATIONSPLAN - SCHEMA D'INSTALLATION -
ESQUEMA DE INSTALACION - INSTALLATIONSCHEMA - INSTALLATIONSRIJNINGAR

MISURE IN mm - DIMENSIONS IN mm - ABMESSUNGEN IN mm - MATEN IN mm
MESURES EN mm - MEDIDAS EN mm - MATEN IN mm

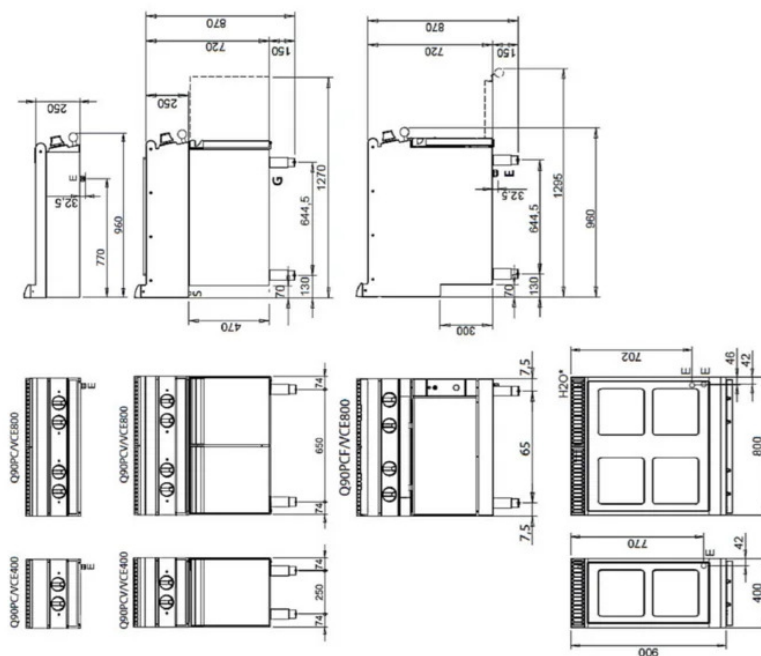

Legenda - Legende - Key - Leyenda - Legenda

E Pressacavo entrata linea elettrica - Stopfbuchse - Electric cable stress relief

Pressacavo de cable el. - Placable - Elektrische kabelwartel

H20* Attacco arrivo acqua - Wasseranschluss - Water inlet - Arrivée eau - Wateraansluiting
EN ISO 228-1 G 3/4

ELECTRIC COOKER 4 GLASS-CERAMIC ZONES ON OPEN COMPARTMENT

Project
Rev.:
Zone:
Location:



CODICE
CR1015969T4W

MODELLO
QT90PCV/VCE800-T4W

SERIE
BARON 4.0

PRODUCT'S RANGE PLUS



Possibility of setting 2 timers to control cooking. An acoustic signal warns the operator at the end of the set time.

Industry 4.0 ready version.



Flat flush unbreakable glass for easy handling of pans. Temperature of the cooking surface from 70° to 450° C



Power level control via touch screen and adjustment with ergonomic knob

ELECTRIC COOKER 4 GLASS-CERAMIC ZONES ON OPEN COMPARTMENT

Project
Rev.:
Zone:
Location:



CODICE
CR1015969T4W

MODELLO
QT90PCV/VCE800-T4W

SERIE
BARON 4.0

ACCESSORIES

CODE	MODELLO	DESCRIZIONE
CR1357499	4.0IOTPRO	PRO Subscription - Cloud
CR1357479	4.0IOTENTRY	ENTRY Subscription - Cloud