

ELECTRIC COOKER 4 GLASS-CERAMIC ZONES ON ELECTRIC OVEN

Project
Rev.:
Zone:
Location:



CODICE
CR1015989

MODELLO
Q90PCF/VCE800

SERIE
QUEEN 9

GENERAL CHARACTERISTICS

It is the choice of those who need maximum strength and power. Queen9 is distinguished by its 900 mm depth, a 20/10-thick work surface, double-crown burners, and the use of elegant stainless steel with a Scotch Brite finish.

Details that not only offer maximum functionality and aesthetics, but also take into account the practical and ergonomic needs of those who work.

The extreme freedom of composition allows top models to be combined with accessorizable oven and neutral base units, even with hygienic finishes.

With more than 350 models immediately available in the catalog, Queen9 is already ready to start giving its best.

In addition, all equipment that makes up a Queen9 kitchen is certified in compliance with international standards, including CE, GAR, AGA and others.



TECHNICAL SPECIFICATIONS

Unbreakable watertight glass-ceramic top.

Cooking zones marked with 27x27 cm square silkscreen printing.

4 kw single zone power.

Temperature regulation from 70-450°C by thermostat.

Heating activation light and residual heat indicator light.

Electric oven

Groups of stainless steel heating elements placed on the ceiling and under the sole of the firing chamber.

Thermostatic temperature control in the chamber from 100°C to 300°C.

Warning light indicating "equipment under voltage."

Indicator light indicating that the set temperature has been reached.

A temperature regulator sets the temperature and this permits to select two sizes of the heating zone according to the size of the pot bottom.

Firing surface temperature 70° to 450° C

Thanks to the jet-proofing certification (IPX5) obtained through specific tests, knobs and under-knobs can be washed at the end of the working day without compromising functionality and safety.

The front bar is a comfortable foothold for the cook; it keeps a safe distance from the worktop and thus protects against accidental collisions with what is resting on the worktops and at the same time the handles.

ELECTRIC COOKER 4 GLASS-CERAMIC ZONES ON ELECTRIC OVEN

Project
Rev.:
Zone:
Location:



CODICE
CR1015989

MODELLO
Q90PCF/VCE800

SERIE
QUEEN 9

Technical Information

SPECIFICATION	DATA
MATERIAL	CR1015989
DEFINITION	Q90NPCF/VCE800 VETROCERAMICA ELE.M80C/FE
COMMERCIAL LINE	QUEEN
SUPPLY	ELECTRICS
DIM. WIDTH	800 mm
DIM. PRODUCTIVITY	900 mm
DIM. HEIGHT	870 mm
NET WEIGHT	139.86 Kg
VOLUME (net)	0.626
PACKAGE LENGTH	1030 mm
PACKAGE WIDTH	1180 mm
PACKAGING HEIGHT	840 mm
PACKAGE VOLUME	1,021 m3
GROSS PACKING WEIGHT	155.4 Kg
STANDARD POWER SUPPLY	380-415V 3N
FREQUENCY	50-60 Hz
ELECTRICAL POWER	22 kW
N. FIRES/PLATES	QUATTRO FUOCHI
IP GRADE	IPX4
CERTIFIED MODEL	Q90PCF/VCE800

ELECTRIC COOKER 4 GLASS-CERAMIC ZONES ON
ELECTRIC OVEN

CODICE
CR1015989

MODELLO
Q90PCF/VCE800

SERIE
QUEEN 9

Project
Rev.:
Zone:
Location:



SCHEMA DI INSTALLAZIONE - INSTALLATION DIAGRAM - INSTALLATIONSPLAN - SCHEMA D'INSTALLATION -
ESQUEMA DE INSTALACION - INSTALLATIONSCHEMA - INSTALLATIONSRIJNINGAR

MISURE IN mm - DIMENSIONS IN mm - ABMESSUNGEN IN mm -
MESURES EN mm - MEDIDAS EN mm - MATEN IN mm

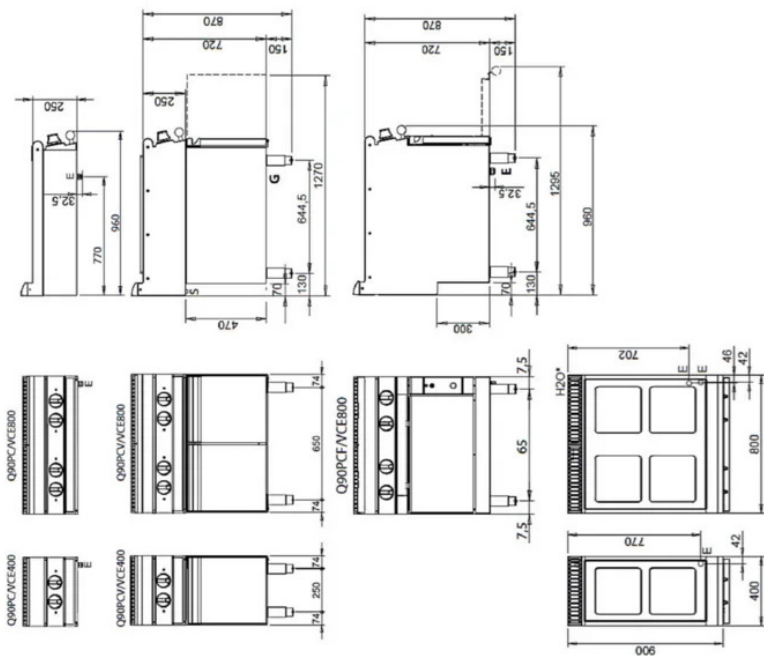

Legenda - Legende - Key - Légende - Leyenda - Legenda

E Pressacavo entrata linea elettrica - Stopfbuchse - Electric cable stress relief

Pressacavo entrada línea eléctrica - Stopfbuchse - Electric cable stress relief

Pressacavo entrée de câble él. - Placable - Elektrische kabelwartel

Pressacavo arrivo acqua - Wasseranschluss - Water inlet - Arrivée eau - Wateraansluiting

EN ISO 228-1 G 3/4

ELECTRIC COOKER 4 GLASS-CERAMIC ZONES ON ELECTRIC OVEN

Project
Rev.:
Zone:
Location:



CODICE
CR1015989

MODELLO
Q90PCF/VCE800

SERIE
QUEEN 9

PRODUCT'S RANGE PLUS



Unbreakable flush-mounted glass
for easy handling of pans.



A temperature regulator sets the
temperature and this permits to
select two sizes of the heating zone
according to the size of the pot
bottom.



Firing surface temperature 70° to
450° C