

# ELECTRIC COOKER 2 ZONES GLASS-CERAMIC TOP VERSION

Project .....  
Rev.: .....  
Zone: .....  
Location: .....



CODICE  
CR1015929T4W

MODELLO  
QT90PC/VCE400-T4W

SERIE  
BARON 4.0

## GENERAL CHARACTERISTICS

From the solid foundation of Baron tradition, comes the new Queen 4.0 kitchen, even more practical, more accessorized, more technological.

An evolution in the field of professional kitchens.

Queen 4.0 is perfectly designed in detail to speed up and simplify every task of preparation, cooking, tidying up, and cleaning in the kitchen, and stand by you every day as a true ally in your work.



## TECHNICAL SPECIFICATIONS

Unbreakable watertight glass-ceramic top.

Cooking zones marked with 27x27 cm square silkscreen printing.

4 kw single zone power.

Temperature regulation from 70-450°C by thermostat.

Possibility of setting 2 timers to control cooking.

An acoustic signal alerts the operator at the end of the set time.

The temperature is regulated by means of an energy regulator, which allows two heating zone widths to be selected according to the size of the pan bottom.

Firing surface temperature 70° to 450° C

Data collection, operation monitoring, remote control are just some of the possibilities that connectivity puts at your disposal.

Thanks to the jet-proofing certification (IPX5) obtained through specific tests, knobs and under-knobs can be washed at the end of the working day without compromising functionality and safety.

The front bar is a comfortable foothold for the cook; it keeps a safe distance from the worktop and thus protects against accidental collisions with what is resting on the worktops and at the same time the handles.

# ELECTRIC COOKER 2 ZONES GLASS-CERAMIC TOP VERSION

Project .....  
Rev.: .....  
Zone: .....  
Location: .....



CODICE  
CR1015929T4W

MODELLO  
QT90PC/VCE400-T4W

SERIE  
BARON 4.0

## Technical Information

SPECIFICATION	DATA
MATERIAL	CR1015929T4W
SUPPLY	ELECTRICS
DIM. WIDTH	400 mm
DIM. PRODUCTIVITY	900 mm
DIM. HEIGHT	250 mm
STANDARD POWER SUPPLY	380-415V 3N
ELECTRICAL POWER	8 kW

## ELECTRIC COOKER 2 ZONES GLASS-CERAMIC TOP VERSION

Project .....  
Rev.: .....  
Zone: .....  
Location: .....



CODICE  
**CR1015929T4W**

MODELLO  
**QT90PC/VCE400-T4W**

SERIE  
**BARON 4.0**

SCHEMA DI INSTALLAZIONE - INSTALLATION DIAGRAM - INSTALLATIONSPLAN - SCHEMA D'INSTALLATION -  
ESQUEMA DE INSTALACION -INSTALLATIONSCHEMA - INSTALLATIONSRIJTNINGAR

MISURE IN mm - DIMENSIONS IN mm - ABMESSUNGEN IN mm  
MESURES EN mm - MEDIDAS EN mm - MATEN IN mm

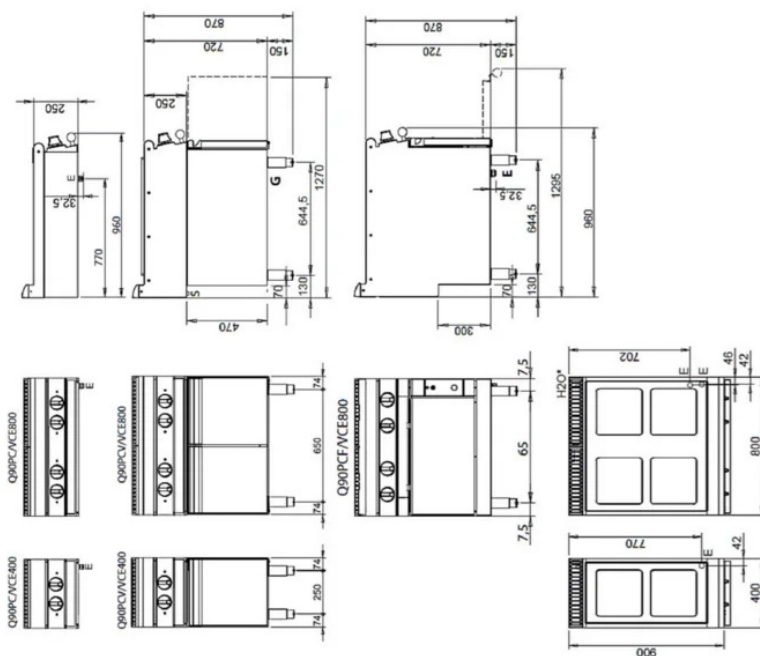

Legenda - Legende - Key - Légende - Leyenda - Legenda

**E** Pressacavo entrata linea elettrica - Stopbuchse - Electric cable stress relief

Pressa étoupe de cable él. - Pisacable - Elektrische kabelwattel

**H20\*** Attacco arrivo acqua - Wasseranschluss - Water inlet - Arrivée eau - Union de agua - Wateraansluiting  
EN ISO 228-1 G 3/4

# ELECTRIC COOKER 2 ZONES GLASS-CERAMIC TOP VERSION

Project .....  
Rev.: .....  
Zone: .....  
Location: .....



CODICE  
CR1015929T4W

MODELLO  
QT90PC/VCE400-T4W

SERIE  
BARON 4.0

## PRODUCT'S RANGE PLUS



Possibility of setting 2 timers to control cooking. An acoustic signal warns the operator at the end of the set time.

Industry 4.0 ready version.



Flat flush unbreakable glass for easy handling of pans. Temperature of the cooking surface from 70° to 450° C



Power level control via touch screen and adjustment with ergonomic knob

ELECTRIC COOKER 2 ZONES GLASS-CERAMIC TOP  
VERSION

CODICE	MODELLO	SERIE
CR1015929T4W	QT90PC/VCE400-T4W	BARON 4.0

Project .....  
Rev.: .....  
Zone: .....  
Location: .....



ACCESSORIES

CODE	MODELLO	DESCRIZIONE
CR1357499	4.0IOTPRO	PRO Subscription - Cloud
CR1357479	4.0IOTENTRY	ENTRY Subscription - Cloud