

GAS FRY-TOP SMOOTH CHROME-PLATED PLATE - ON CABINET WITH DOORS

Project
Rev.:
Zone:
Location:



CODICE
CR1010589

MODELLO
N550FTTVP/G905

SERIE
SERIE GIANO

GENERAL CHARACTERISTICS

The Giano pass-through Series appliances are characterized by their great versatility, the perfect combination of modules, and their robustness, thanks to 2 mm thick laser-cut AISI 304 cooking surfaces.

These peculiarities make it possible to make firing blocks according to specific customer requirements.

Reliability and high efficiency are ensured by the use of tested components and the high efficiency of the heating elements used. Support bases can be equipped with pass-through ovens, ventilated hot cabinets, neutral, or cantilevered or bridged.

Machines all complying with CE regulations.

RAL paint treatment can be requested.



TECHNICAL SPECIFICATIONS

Stainless steel outer coatings and Scotch Brite finish.

Tops with a thickness of 2 mm.

Contoured dashboards with controls angled toward the operator.

Cooking plate made of soft iron (normal plate), coated with polished hard chrome (chrome plate).

Large fat collection drawer.

Self-stabilized flame burner.

Temperature regulation by thermostatic valve with safety thermocouple (115°C-300°C).

Piezo ignition.

GAS FRY-TOP SMOOTH CHROME-PLATED PLATE - ON CABINET WITH DOORS

Project
Rev.:
Zone:
Location:



CODICE
CR1010589

MODELLO
N550FTTVP/G905

SERIE
SERIE GIANO

Technical Information

SPECIFICATION	DATA
MATERIAL	CR1010589
DEFINITION	N550FTTVP/G905 FTG LIS.CROM. M90 A/G C/P
COMMERCIAL LINE	SERIE 1100
SUPPLY	GAS
DIM. WIDTH	900 mm
DIM. PRODUCTIVITY	550 mm
DIM. HEIGHT	870 mm
NET WEIGHT	84 Kg
VOLUME (net)	0.431
PACKAGE LENGTH	650 mm
PACKAGE WIDTH	940 mm
PACKAGING HEIGHT	1280 mm
PACKAGE VOLUME	0,782 m3
GROSS PACKING WEIGHT	110 Kg
GAS POWER	9.5
GAS POWER (G25.3/25mbar)	9,00
GAS/REFRIGERANT TYPE	GPL 28-30/37 mbar
CERTIFIED MODEL	N550FTTVP/G905

GAS FRY-TOP SMOOTH CHROME-PLATED PLATE - ON
CABINET WITH DOORS

Project
Rev.:
Zone:
Location:



CODICE
CR1010589

MODELLO
N550FTTVP/G905

SERIE
SERIE GIANO

SCHEMA DI INSTALLAZIONE - INSTALLATION DIAGRAM - INSTALLATIONSPLAN - SCHÉMA D'INSTALLATION -
ESQUEMA DE INSTALACION -INSTALLATIESCHEMA - INSTALLATIONSRIJNINGAR

MISURE IN mm - DIMENSIONS IN mm - ABMESSUNGEN IN mm
MESURES EN mm - MEDIDAS EN mm - MATEN IN mm

NFT11C9GT	EBGT4T...
550/90FTT...	N550FTT/G...

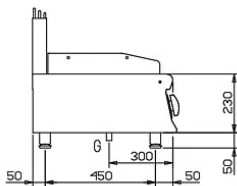
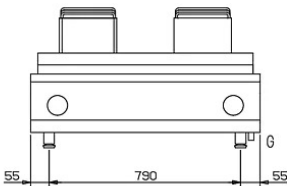

NFT119GT	EBGT4A... EBGT4G...
550/90FTTG...	N550FTTVP/G... N550FTTV/G...

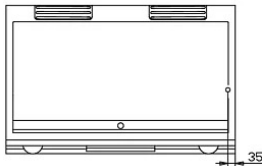
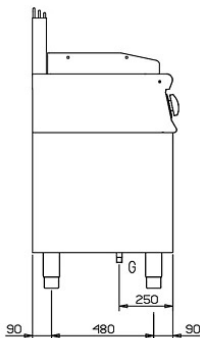
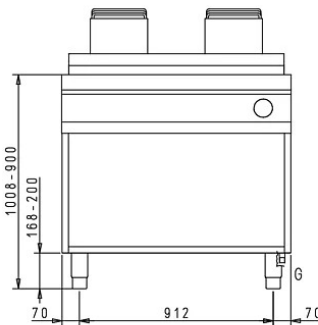

- Legenda - Legende - Key - Legende - Leyenda - Legenda
- E Pressacavo entrata linea elettrica - Stopfbuchse
Electric cable stress relief - Presse etoupe de cable el
Pisacable - Elektrische kabelwartel
- G Attacco arrivo gas - Gasanschluss - Gas connection
Arrive gaz - Union da gas - Gasaanluiting
EN 10226-1 R 1/2; EN ISO 228-1 G 1/2 (DK)

GAS FRY-TOP SMOOTH CHROME-PLATED PLATE - ON CABINET WITH DOORS

Project
Rev.:
Zone:
Location:



CODICE
CR1010589

MODELLO
N550FTTVP/G905

SERIE
SERIE GIANO

ACCESSORIES

CODE	MODELLO	DESCRIZIONE
CR1011729	1100KC4	DRAWER KIT FOR NEUTRAL BASE 450 MM
CR1011739	1100KC8	DRAWER KIT FOR NEUTRAL BASE 900 MM
BN418032900010	45/1100	JANUS SERIES DOOR
BN2564200	GA	FEET - HIGH LEG
BN2564210	GB	FEET - LOW LEG
CR1011769	NZA135	FRONT SKIRTING - MODULE 1350
CR1011779	NZA180	FRONT SKIRTING - MODULE 1800
CR1011789	NZA225	FRONT SKIRTING - MODULE 2250
CR1011799	NZA270	FRONT SKIRTING - MODULE 2700
BN2593590	CMF1109	FRONT HANDRAIL
BN2593591	CMF1113	FRONT HANDRAIL
BN2593592	CMF1118	FRONT HANDRAIL
BN2593593	CMF1122	FRONT HANDRAIL
BN2593594	CMF1127	FRONT HANDRAIL
BN2593580	CMA1109	PERIMETER HANDRAIL
BN2593581	CMA1113	PERIMETER HANDRAIL
BN2593582	CMA1118	PERIMETER HANDRAIL
BN2593583	CMA1122	PERIMETER HANDRAIL
BN2593584	CMA1127	PERIMETER HANDRAIL
BN2593599	CMT11	END ELEMENT FOR TOP
CGPT 1190	CGPT 1190	AMI HOLDER STRUCTURE
CGPT 11135	CGPT 11135	AMI HOLDER STRUCTURE
CGPT 11180	CGPT 11180	AMI HOLDER STRUCTURE
CGPT 11225	CGPT 11225	AMI HOLDER STRUCTURE
CGPT 1127	CGPT 1127	AMI HOLDER STRUCTURE
CCPG110N	CCPG110N	NEUTRAL PILLAR
ST1113A	ST1113A	ALUMINISED STRUCTURE
ST1118A	ST1118A	ALUMINISED STRUCTURE
ST1122A	ST1122A	ALUMINISED STRUCTURE
ST1127A	ST1127A	ALUMINISED STRUCTURE
ST1113X	ST1113X	STAINLESS STEEL STRUCTURE
ST1118X	ST1118X	STAINLESS STEEL STRUCTURE
ST1122X	ST1122X	STAINLESS STEEL STRUCTURE
ST1127X	ST1127X	STAINLESS STEEL STRUCTURE
SP1113X	SP1113X	STAINLESS STEEL STRUCTURE
SP1118X	SP1118X	STAINLESS STEEL STRUCTURE
SP1122X	SP1122X	STAINLESS STEEL STRUCTURE
BN2593475	BV-RG11	PAIR OF GN 1/1 GRID HOLDERS
BN0221000001	20/1100MCRP	WATER COLUMN SUPPORT WITH TAP - GIANO SERIES
BN2590145	RUB110	Faucet 45x55x62 65 H
CR1355819	CR1355819	GIANO SERIES WHEEL KIT
CR1011749	NZA45	FRONT SKIRTING - MODULE 450
CR1011759	NZA90	FRONT SKIRTING - MODULE 900

GAS FRY-TOP SMOOTH CHROME-PLATED PLATE - ON
CABINET WITH DOORS

Project
Rev.:
Zone:
Location:



CODICE
CR1010589

MODELLO
N550FTTVP/G905

SERIE
SERIE GIANO

CR1011809

NZL110

SIDE PLINTH THROUGH