

Blast Chiller/Freezer 16 GN 1/1 - 600x400 - Built-in Motor

Project
Rev.:
Zone:
Location:



CODICE
BN2ABF370301

MODELLO
BE161

SERIE
BLAST CHILLERS

GENERAL CHARACTERISTICS

Baron professional blast chiller
with function of: Blast chilling - Deep-freezing, supplied with core
probe as standard and electronic control with LCD display
interface.

This professional blast chiller can work in automatic cycle or with
settable time.

Baron professional blast chillers use R452A refrigerant gas, have a
timed manual defrost function and are prepared for the defrost
water collection tray (GN 1/1 H40 size).

Draining the defrosting water is easy thanks to the moulded
bottom.



TECHNICAL SPECIFICATIONS

Monocoque construction in AISI304 Scotch-Brite satin stainless steel
Internal rounded structure in AISI 304 stainless steel
Internal molded bottom with central drain
PU, HCFC free insulation, thickness 60 mm, density 42 kg/m³
Evaporating coil in copper-aluminum, with anticorrosion cataphoresis
treatment, with opening deflector for inspection
Anti-condensation resistance placed under the frame of the stop
Ergonomic full-height handle and magnetic seal on 4 sides of the door
heated single point probe
Manual defrosting device
Electronic fans
Environmentally-friendly R452A gas
Electronic membrane control. Front-mounted, easy-access IPX4
organized control panel.

Monocoque construction in AISI304 Scotch-Brite satin stainless steel

Internal rounded structure in AISI 304 stainless steel

Internal molded bottom with central drain

PU, HCFC free insulation, thickness 60 mm, density 42 kg/m³

Evaporating coil in copper-aluminum, with anti-corrosion cataphoresis
treatment, with opening deflector for inspection

Condensing coil in copper with high performance aluminum fins

Anti-condensation resistance placed under the frame of the stop

Ergonomic full-height handle and magnetic seal on 4 sides of the door
heated single point probe

Manual defrosting device

Blast Chiller/Freezer 16 GN 1/1 - 600x400 - Built-in Motor

Project
Rev.:
Zone:
Location:



CODICE
BN2ABF370301

MODELLO
BE161

SERIE
BLAST CHILLERS

Technical Information

SPECIFICATION	DATA
MATERIAL	BN2ABF370301
DEFINITION	ABBATTITORE/SURGELATORE 16 GN 1/1 - 600x400 - MOTORE A BORDO
SUPPLY	ELECTRICS
DIM. WIDTH	790 mm
DIM. PRODUCTIVITY	850 mm
DIM. HEIGHT	1950 mm
NET WEIGHT	220 Kg
PACKAGE LENGTH	940 mm
PACKAGE WIDTH	850 mm
PACKAGING HEIGHT	2045 mm
PACKAGE VOLUME	1.63 m3
GROSS PACKING WEIGHT	225 Kg
STANDARD POWER SUPPLY	380-420/3/50+N
ELECTRICAL POWER	3.158 kW
GAS/REFRIGERANT TYPE	R452a
REFRIGERATION POWER	9.83
CAPACITY	360

Blast Chiller/Freezer 16 GN 1/1 - 600x400 - Built-in Motor

Project
Rev.:
Zone:
Location:



CODICE BN2ABF370301	MODELLO BE161	SERIE BLAST CHILLERS
------------------------	------------------	-------------------------

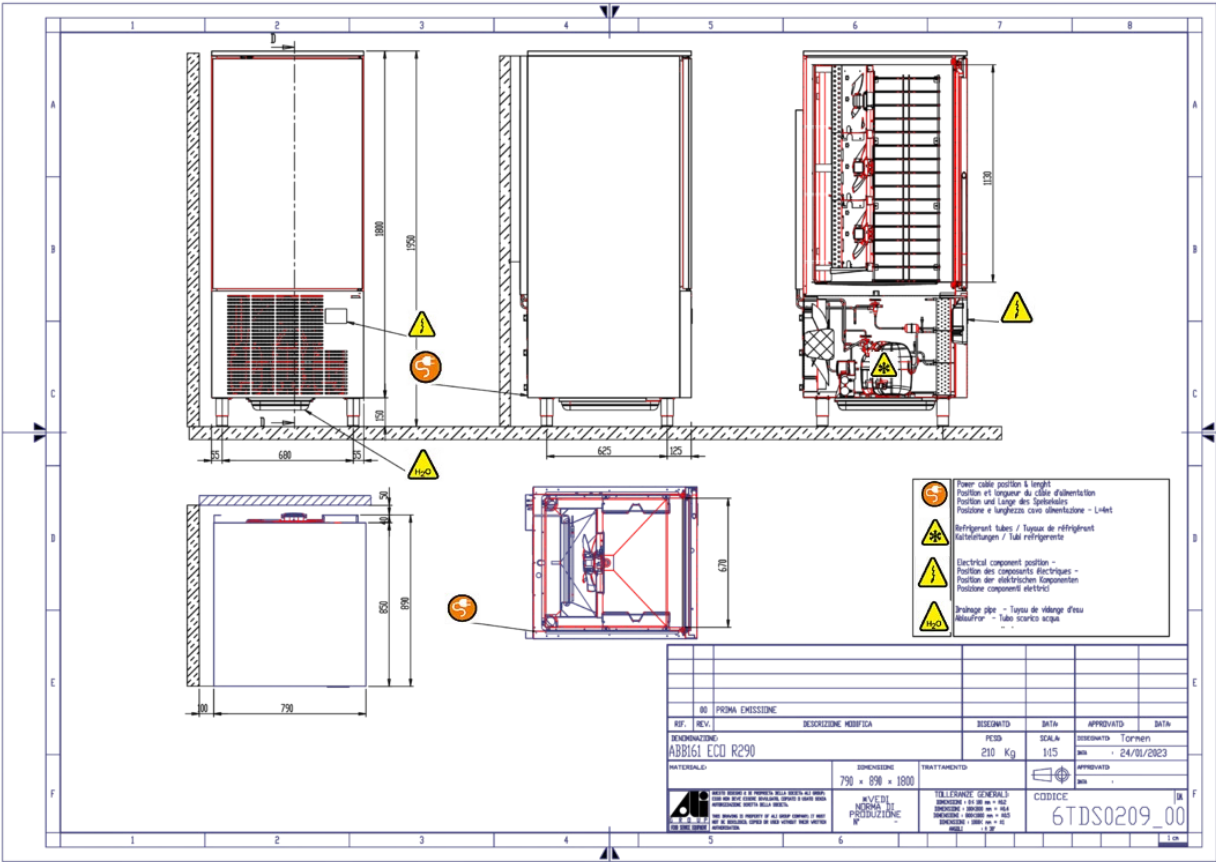

Blast Chiller/Freezer 16 GN 1/1 - 600x400 - Built-in Motor

Project
Rev.:
Zone:
Location:



CODICE
BN2ABF370301

MODELLO
BE161

SERIE
BLAST CHILLERS

PRODUCT'S RANGE PLUS



Copper-aluminum evaporator coil, with anticorrosive cataphoresis treatment, with flag-opening baffle on hinges, for cleaning



Electronic membrane control. Front-mounted, easy-access IPX4 organized control panel.



AISI 304 stainless steel plate-rack support, with removable ANTI-BRIEFING pairs of AISI 304 stainless steel rails, interlocking positionable every 20 mm for GN1/1 or 600x400.



Heated core probe with 1 measuring point.